

1-800-639-2199

Fax (603) 224-2927

Electrical\Unitil\2-3-12_Assembly_Sales_Rev2

Phoenix Precast Products

Phoenix Precast Products

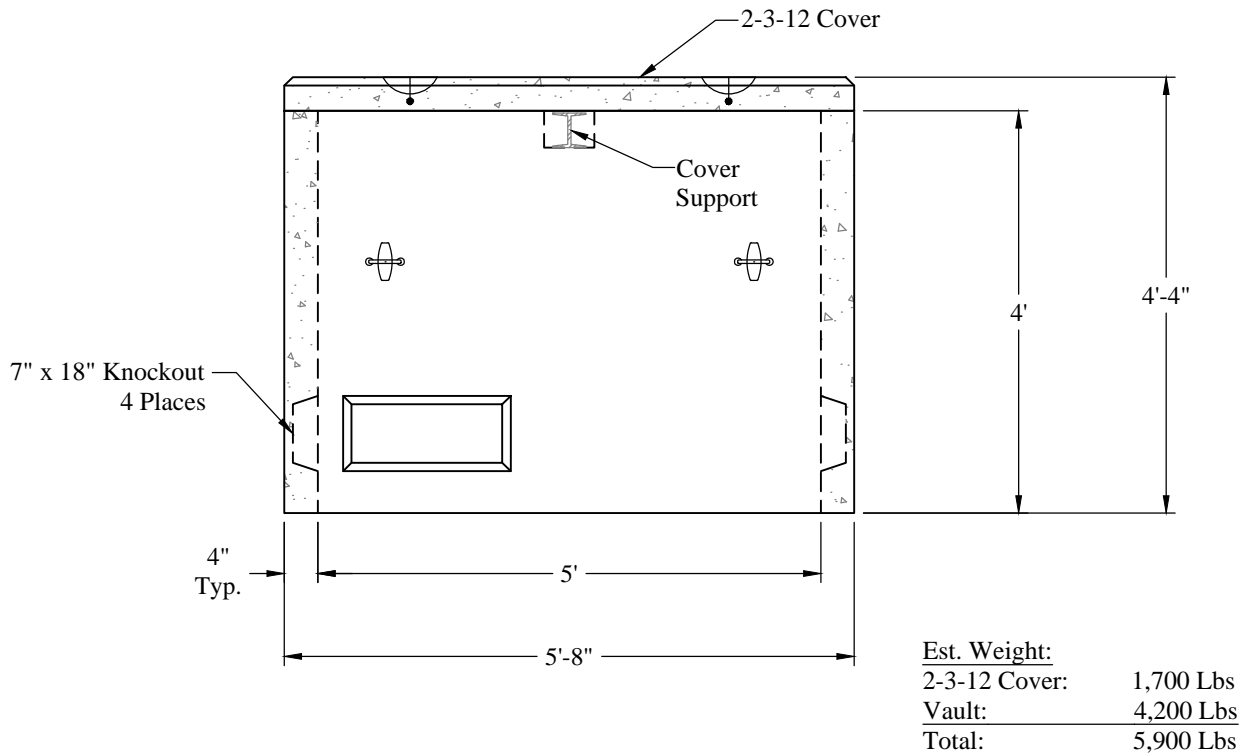
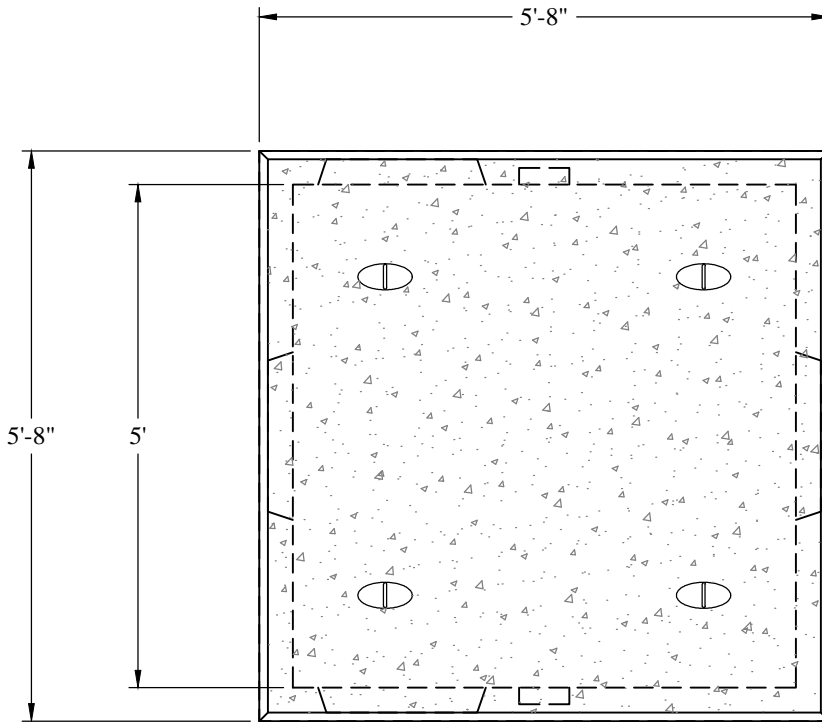

General Notes

1. Concrete: $f_c = 5,000$ psi @ 28 Days Minimum
2. Reinforcement Steel Conforms to:
ASTM A615 Grade 60 Black Deformed Bars

Phoenix
Precast
Products

Unitil 2-3-12
Assembly

P/N: UEH-2312

77 Regional Drive

Concord, NH 03301